



Calcutt FEI Bid Package #2 | Student Dining

100% Bid Documents

Central Falls, RI

Ai3 Project # - 2202.04

Addendum #2

July 10, 2023

The attention of Bidders submitting proposals for Calcutt FEI Bid Package #2 100% Bid Documents is called to the following changes to the Bidding Contract Documents dated June 22, 2023 as prepared by Ai3 Architects, LLC. The items set forth therein below, whether of revision, omission, addition, substitution or clarification are all to be included as changes to Information to Bidders, the Conditions of the Contract, Specifications and Drawings of the Contract.

The number of this Addendum (Number 2) must be entered in the appropriate spaces provided on the Bid Form.

ATTACHMENTS:

Demolition Drawings:

ADD 2-001 Demolition Drawings: remove drawing DA2.11B2 in its entirety and replace with drawing DA2.11B2.

Architectural Drawings:

ADD 2-002 Architectural Drawings: remove drawings A2.21B2, A10.10B2, and A10.11B2 in their entirety and replace with drawings A2.21B2, A10.10B2, and A10.11B2.

END OF ADDENDUM #2

Calcutt FEI Bid Package #2 | Student Dining

100% BID DOCUMENTS CENTRAL

FALLS, RI ADD #2 – PAGE 1

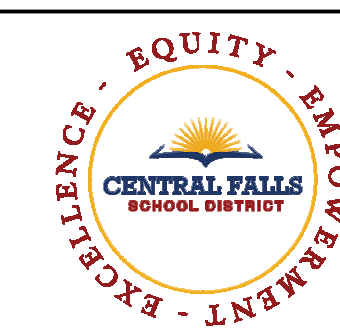

112 WASHINGTON STREET
CENTRAL FALLS, RI 02863

KEYNOTE LEGEND:

DEMOLITION NOTE:

CONTRACTOR SHALL REMOVE ALL EXISTING WALL HUNG TUBE TVS AND BRACKETS IN THEIR ENTIRETY. CONTRACTOR SHALL ASSUME ONE TV AND BRACKET PER EVERY CLASSROOM AND TWO TVS AND BRACKETS IN THE LIBRARY MEDIA CENTER. CONTRACTOR SHALL CONTACT RIRRC (RHODE ISLAND RESOURCE RECOVERY CORPORATION) FOR DISPOSAL OF TVS AND BRACKETS AS ELECTRONIC WASTE VIA THEIR RESOURCE RECOVERY PROGRAM AND PAY ANY AND ALL APPLICABLE FEES ASSOCIATED WITH SAID DISPOSAL. CONTRACTOR SHALL PATCH AND PAINT EXISTING CMU OR DRYWALL TO MATCH SURROUNDING AREA.

#	DEMOLITION TEXT
1	REMOVE EXISTING FLOORING.
2	REMOVE EXISTING CEILING.
3	REMOVE ALL EXISTING PARTITIONS, PLUMBING FIXTURES, AND CASEWORK AS INDICATED.
4	REMOVE ALL CEILING GRIDS AND TILES IN LOCATIONS NOTED ON PLANS AND COORDINATED WITH THE ROOM FINISH SCHEDULE.
5	REMOVE WINDOW UNIT AND ALL ASSOCIATED WOOD BLOCKING, WINDOW TREATMENTS, INTERIOR WOOD TRIM AND APRON AS REQUIRED FOR INSTALLATION OF NEW WORK.
6	REMOVE EXISTING DOOR HARDWARE INCLUDING TRANSOM PANEL, WHERE OCCURS. PREPARE EXISTING DOOR FRAME AS REQUIRED TO RECEIVE SCHEDULED FINISH, DOOR AND HARDWARE. REFER TO DOOR SCHEDULE FOR ADDITIONAL INFORMATION.
7	REMOVE EXISTING DOOR(S), FRAME(S), INCLUDING TRANSOM PANEL(S) AND SIDELITE(S), BLOCKING, TRIM AND THRESHOLDS.
8	REMOVE CEILING MOUNTED DEVICES + LIGHT FIXTURES, AND STORE FOR REUSE. REFER TO ELECTRICAL DRAWINGS FOR ADDITIONAL INFORMATION.
9	REMOVE EXISTING CASEWORK, BUILT-IN SHELVING, LOOSE SHELVING, WARDROBES, BASE AND UPPER CABINETS AND COUNTERTOPS.
10	REMOVE EXISTING PLUMBING FIXTURE(S) AND LINES BACK TO A POINT WHICH WOULD NOT INTERFERE WITH NEW WORK.
11	REMOVE EXISTING GYM EQUIPMENT INCLUDING BUT NOT LIMITED TO PULL UP BAGS, CURTAIN + TRACK, WALL PADS + FASTENERS, BLEACHERS, ROPES. PATCH & PREPARE SURFACE FOR NEW FINISH.
12	REMOVE EXISTING WALL MOUNTED PARTITIONS AND ACCESSORIES. PROVIDE BLOCKING AND FURRING AT RECESSES TO ALIGN WITH EXISTING WALL FINISH TO RECEIVE NEW.
13	REMOVE ALL WALL MOUNTED ITEMS, RESTORE FOR REUSE, AND PREPARE SURFACE FOR NEW FINISH.
14	REMOVE EXISTING TECTUM WALL PANELS. PATCH & PREPARE SURFACE FOR NEW FINISH.
15	REMOVE DOOR, FRAME + HARDWARE IN ITS ENTIRETY.
16	REMOVE DOOR + HARDWARE & PREPARE FRAME FOR NEW DOOR + HARDWARE.
17	REMOVE HARDWARE & PREPARE DOOR + FRAME FOR NEW HARDWARE.
18	PREPARE EXISTING FLOOR FOR INSTALLATION OF NEW POURED EPOXY FLOOR. SEE ARCHITECTURAL DRAWINGS FOR MORE INFORMATION.
19	REMOVE & DISPOSE OF ALL WALL MOUNTED ITEMS NOT SCHEDULED TO REMAIN & PREPARE FOR NEW FINISH MATERIAL. SEE ARCHITECTURAL DRAWINGS FOR MORE INFORMATION.
20	REMOVE & DISPOSE OF EXISTING ACOUSTICAL CEILING TILES. ALL ITEMS ASSOCIATED WITH EXISTING SUSPENSION SYSTEM ARE TO REMAIN. REFER TO ARCHITECTURAL, MECHANICAL, ELECTRICAL, PLUMBING DRAWINGS FOR MORE INFORMATION.
21	REMOVE & DISPOSE OF ALL FINISHED CEILING MATERIALS NOT SCHEDULED TO REMAIN, INCLUDING GYM, AND ALL ITEMS ASSOCIATED WITH CEILING SUSPENSION SYSTEM, ACOUSTICAL TILES, ETC. REFER TO ARCHITECTURAL, MECHANICAL, ELECTRICAL, PLUMBING DRAWINGS FOR MORE INFORMATION. LEAVE EXPOSED STRUCTURE ABOVE CLEAN + FREE OF ALL ITEMS SCHEDULED FOR DEMOLITION FOR INSTALLATION OF NEW WORK.

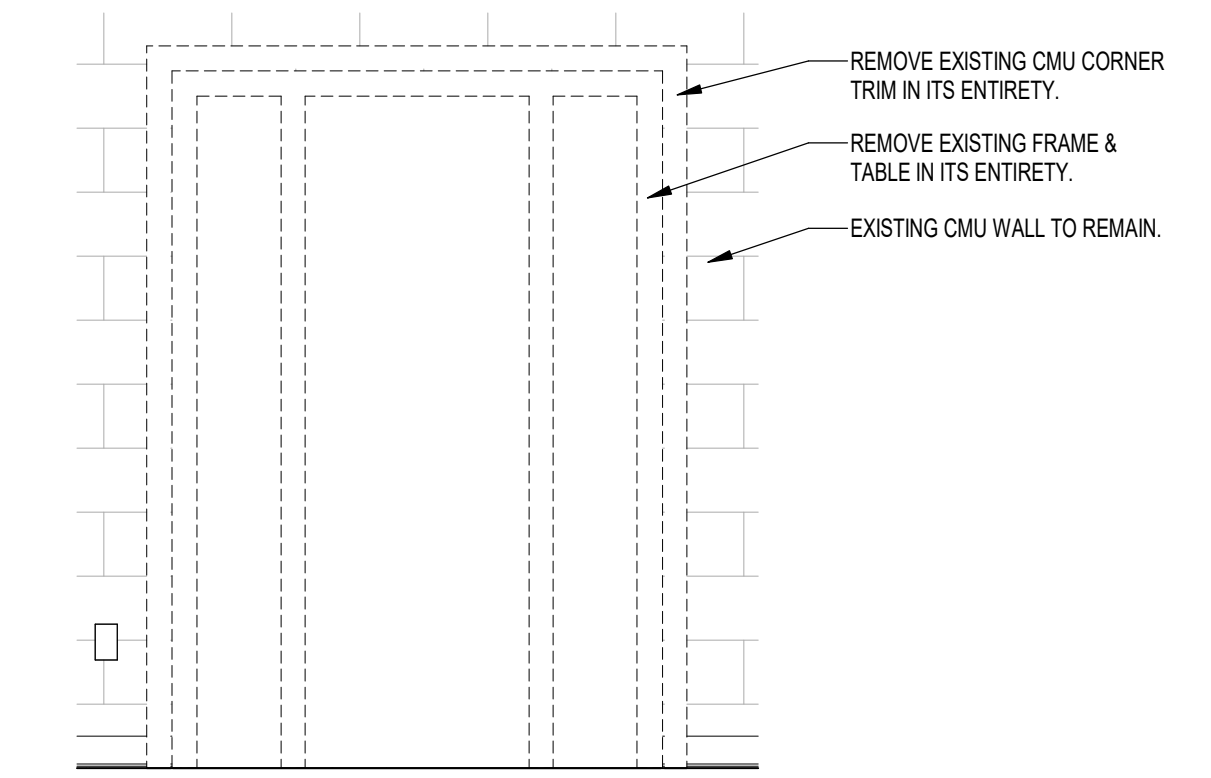
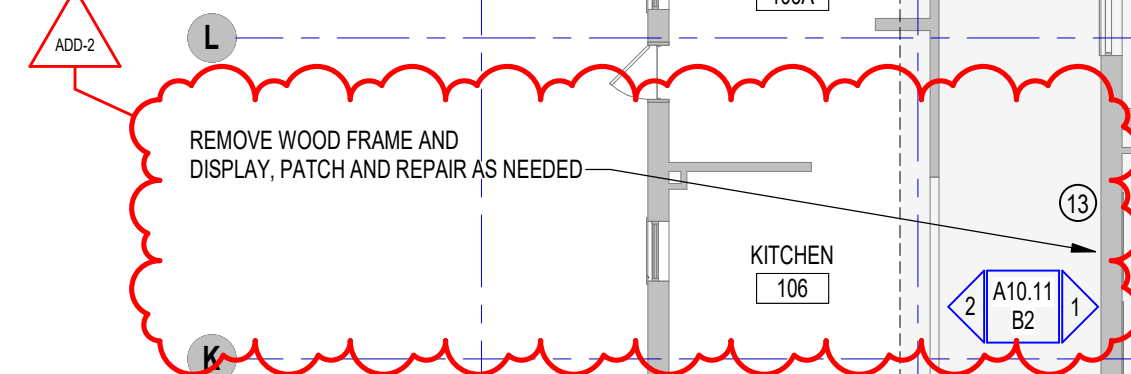
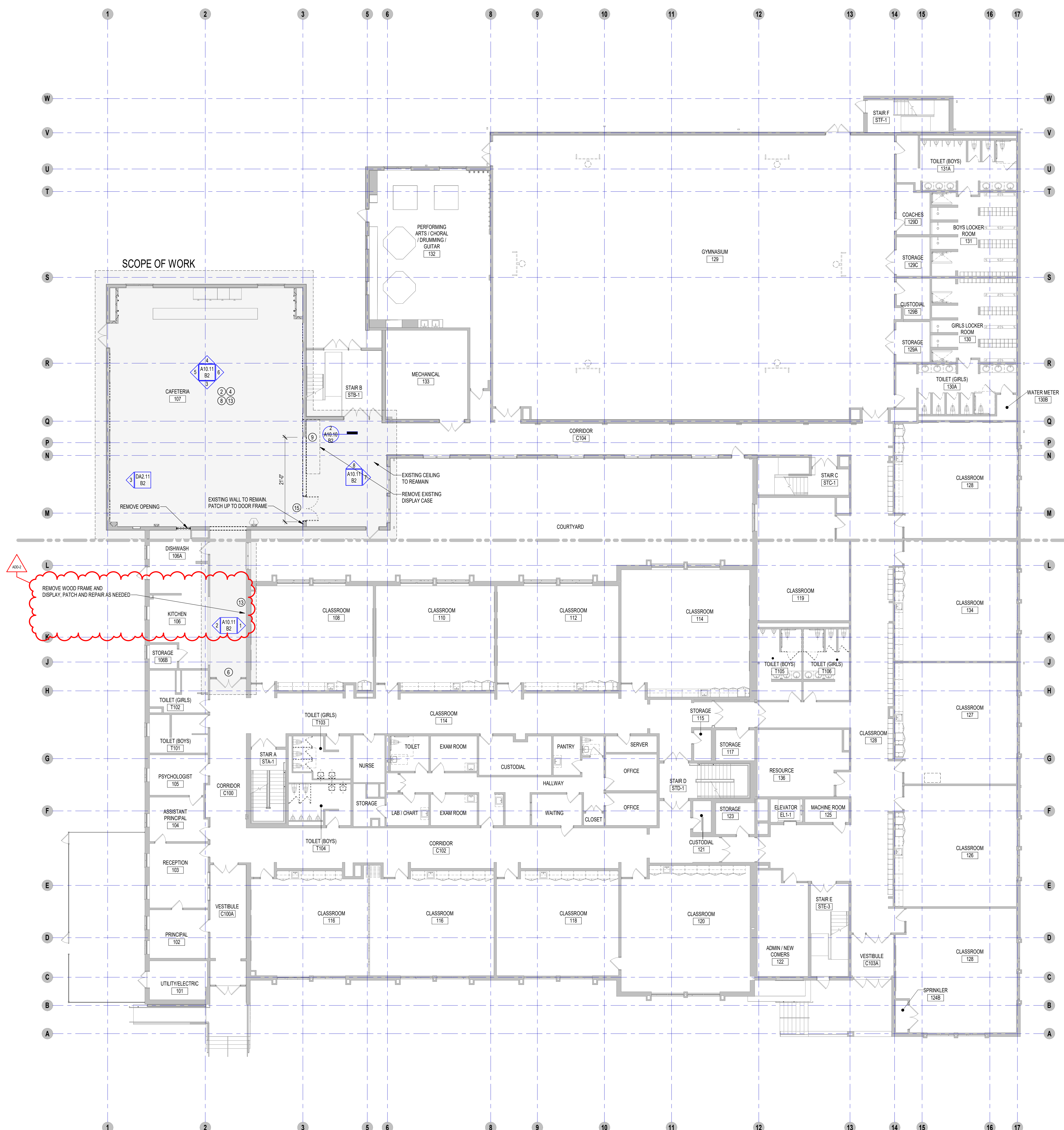

3 ENLARGED INTERIOR ELEVATION Copy 1
1/2" = 1'-0"

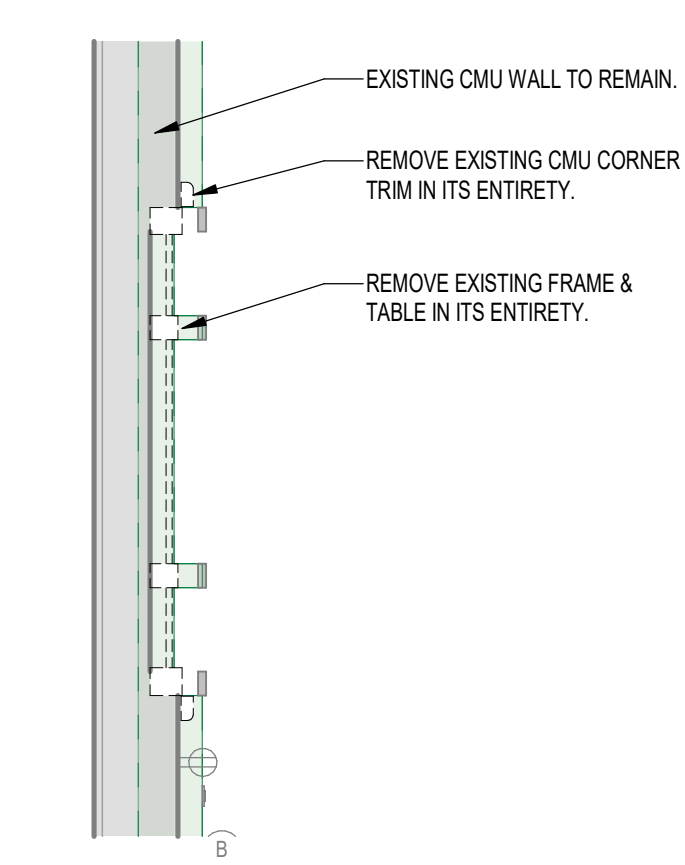

2 ENLARGED PLAN DETAIL
1/2" = 1'-0"

1 FIRST FLOOR DEMOLITION PLAN
3/24" = 1'-0"

ADDENDUM #2 ADD-2 7.10.2023
BID PACKAGE #2

KEY PLAN NORTH ARROW

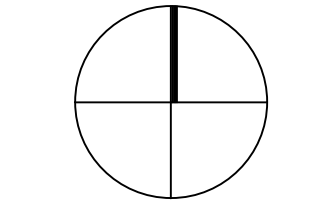

KEYPLAN

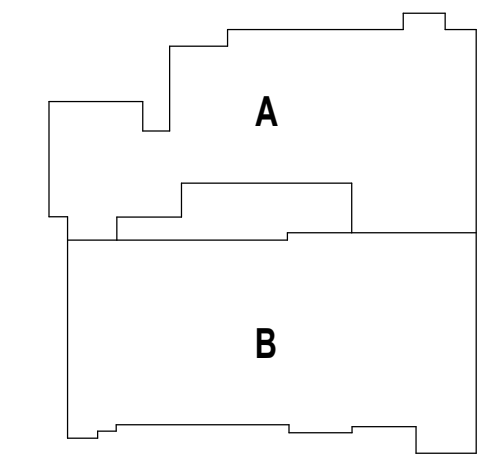

DRAWING NAME:

FIRST FLOOR DEMOLITION PLAN

DRAWN BY: MS / NS
REVIEWED BY: JQ

SCALE: AS INDICATED | DRAWING NUMBER:
JOB NO.: 2202.04
DATE: June 22, 2023 | DA2.11 B2

Copyright © 2022, A3 Architects, LLC



112 WASHINGTON STREET
CENTRAL FALLS, RI 02863

Copyright © 2022 A3 Architects, LLC

KEYNOTE LEGEND:

ADDENDUM #2 ADD-2 7.10.2023

BID PACKAGE #2

KEY PLAN NORTH ARROW

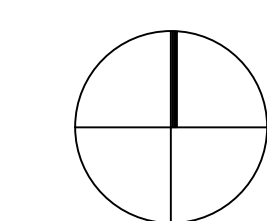

KEYPLAN

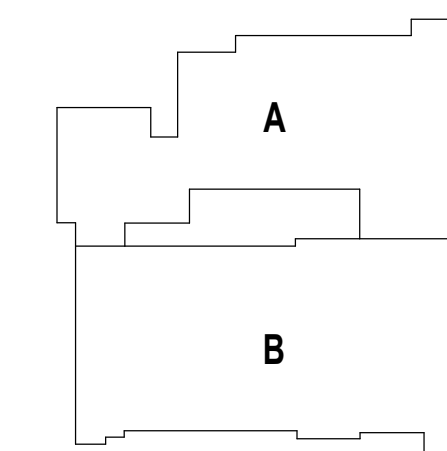

DRAWING NAME:

**STUDENT DINING
ENLARGED RCP**

DRAWN BY: MS

REVIEWED BY: JQ

SCALE: AS INDICATED | DRAWING NUMBER:
JOB NO.: 2202.04
DATE: June 22, 2023 **A2.21 B2**

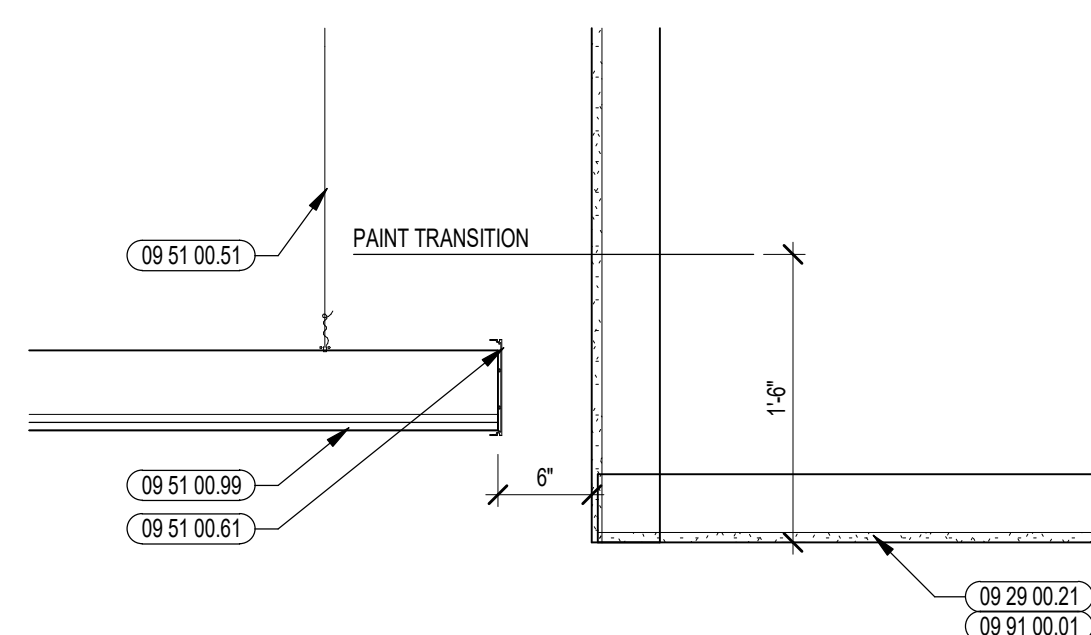
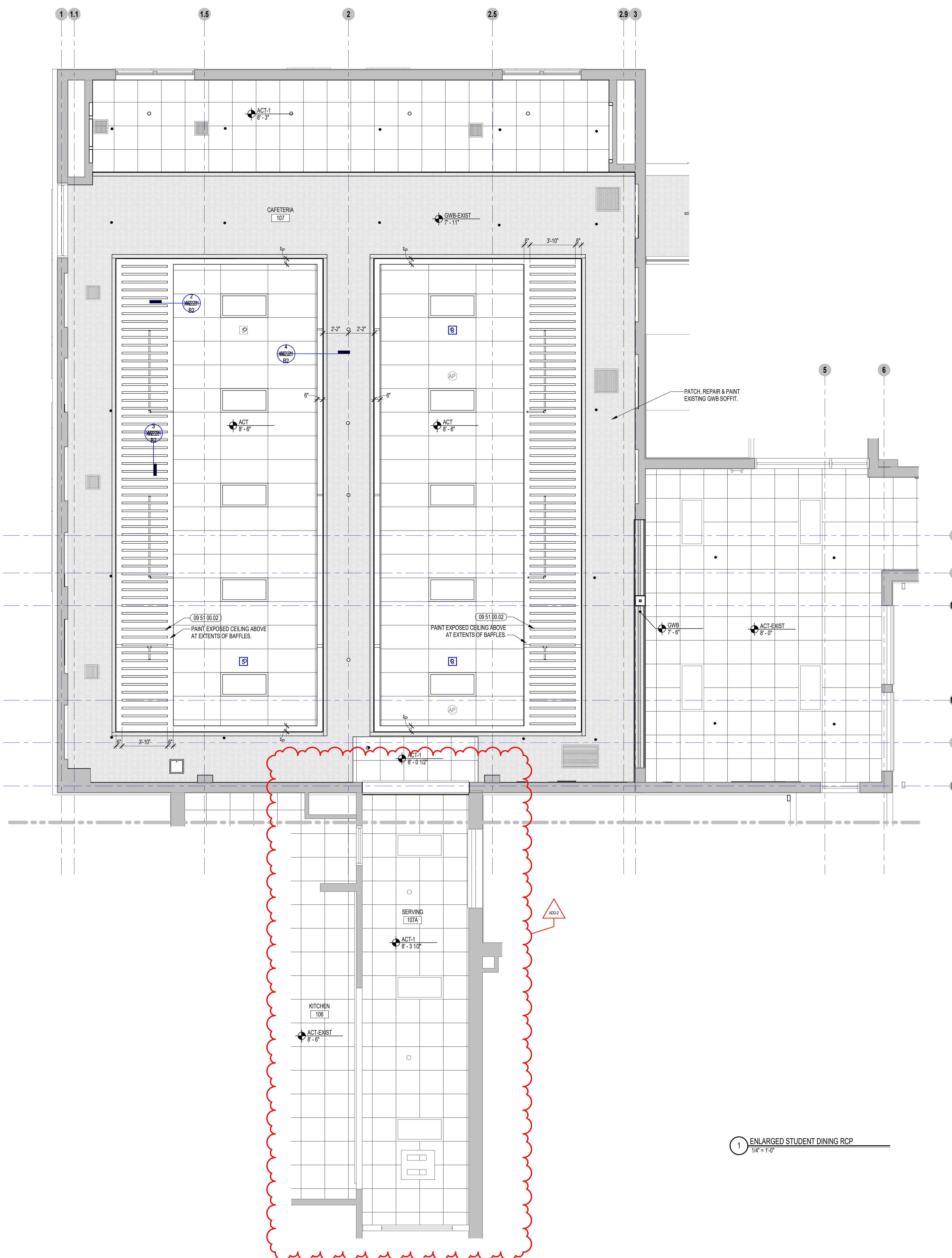

4 ACT CLOUD DETAIL
1" = 1'-0"

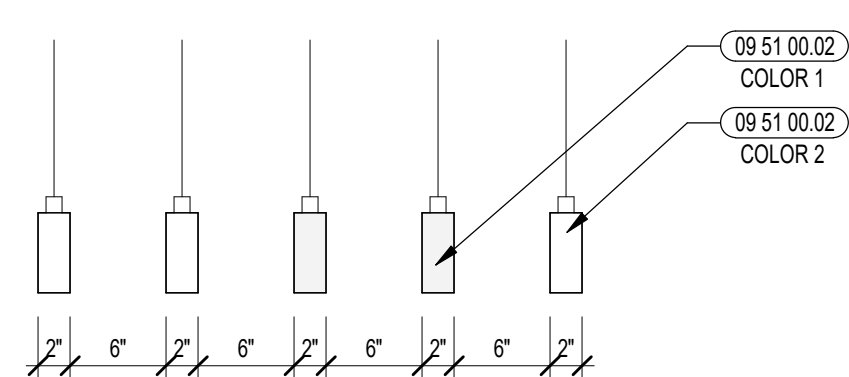

3 ACOUSTIC BAFFLE SECTION DETAIL
1" = 1'-0"

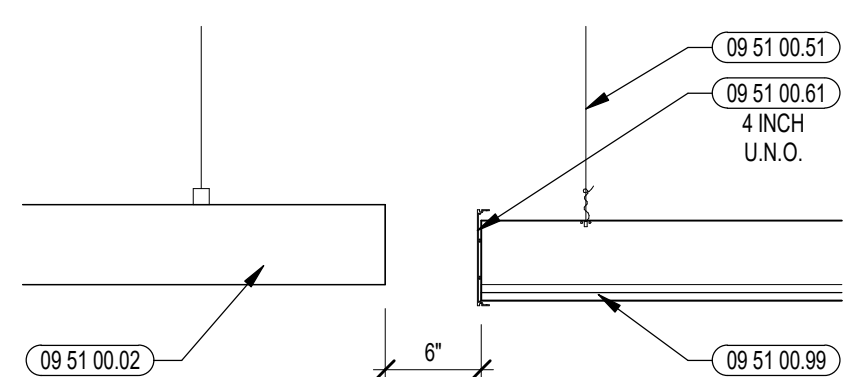

2 AXIOM TRIM SECTION DETAIL
1" = 1'-0"

1 ENLARGED STUDENT DINING RCP
1/4" = 1'-0"



112 WASHINGTON STREET
CENTRAL FALLS, RI 02863

KEYNOTE LEGEND:

- 05 50 00.22 STEEL TUBE - SIZE AS NOTED OR DRAWN
- 06 10 00.23 WOOD BLOCKING - FIRE RETARDANT TREATED - SIZE AS NOTED OR DRAWN
- 06 10 00.99 WOOD BLOCKING - SIZE AS NOTED OR DRAWN
- 06 20 00.21 HARDWOOD TRIM - 1 1/2 INCH - TRANSPARENT FINISH
- 06 20 00.23 HARDWOOD TRIM - 3/4 INCH - TRANSPARENT FINISH
- 06 40 00.33 HARDWOOD VENEER PLYWOOD - 3/4 INCH - TRANSPARENT FINISH
- 07 92 00.01 JOINT SEALANT - TYPE AS REQUIRED
- 09 22 16.03 METAL STUD 3.58 INCH - 16 INCHES O.C. MAX
- 09 29 00.01 5/8 INCH GYPSUM BOARD - LEVEL 4 FINISH - 1 LAYER
- 09 65 13.01 RUBBER BASE - 4 INCH
- 09 91 00.01 PAINT - SEE SCHEDULE

ADDENDUM #2 ADD-2 7.10.2023
BID PACKAGE #2

KEY PLAN NORTH ARROW

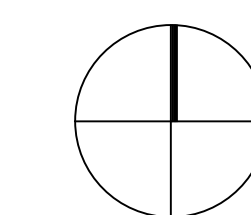

KEYPLAN

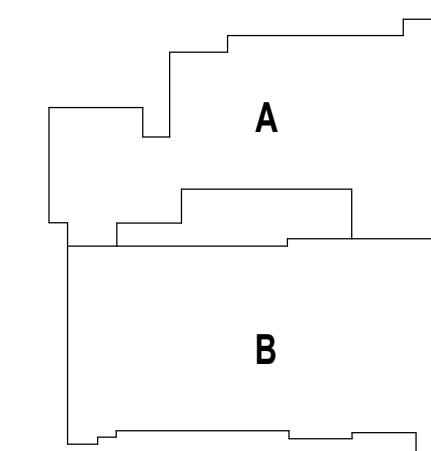

DRAWING NAME:

STUDENT DINING ENLARGED PLAN

DRAWN BY: MS

REVIEWED BY: JQ

SCALE: AS INDICATED | DRAWING NUMBER:
JOB NO.: 2202.04
DATE: June 22, 2023 **A10.10 B2**

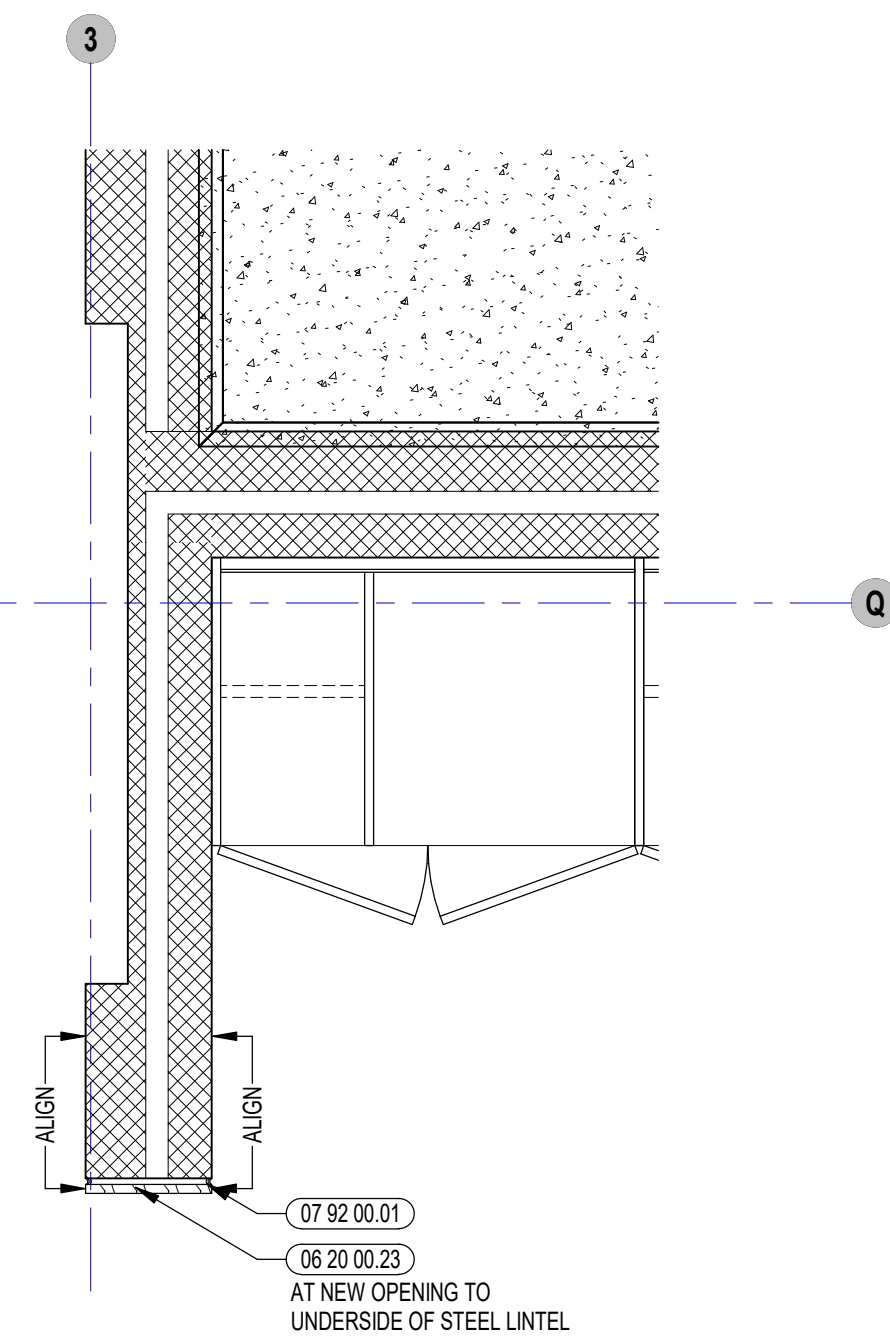
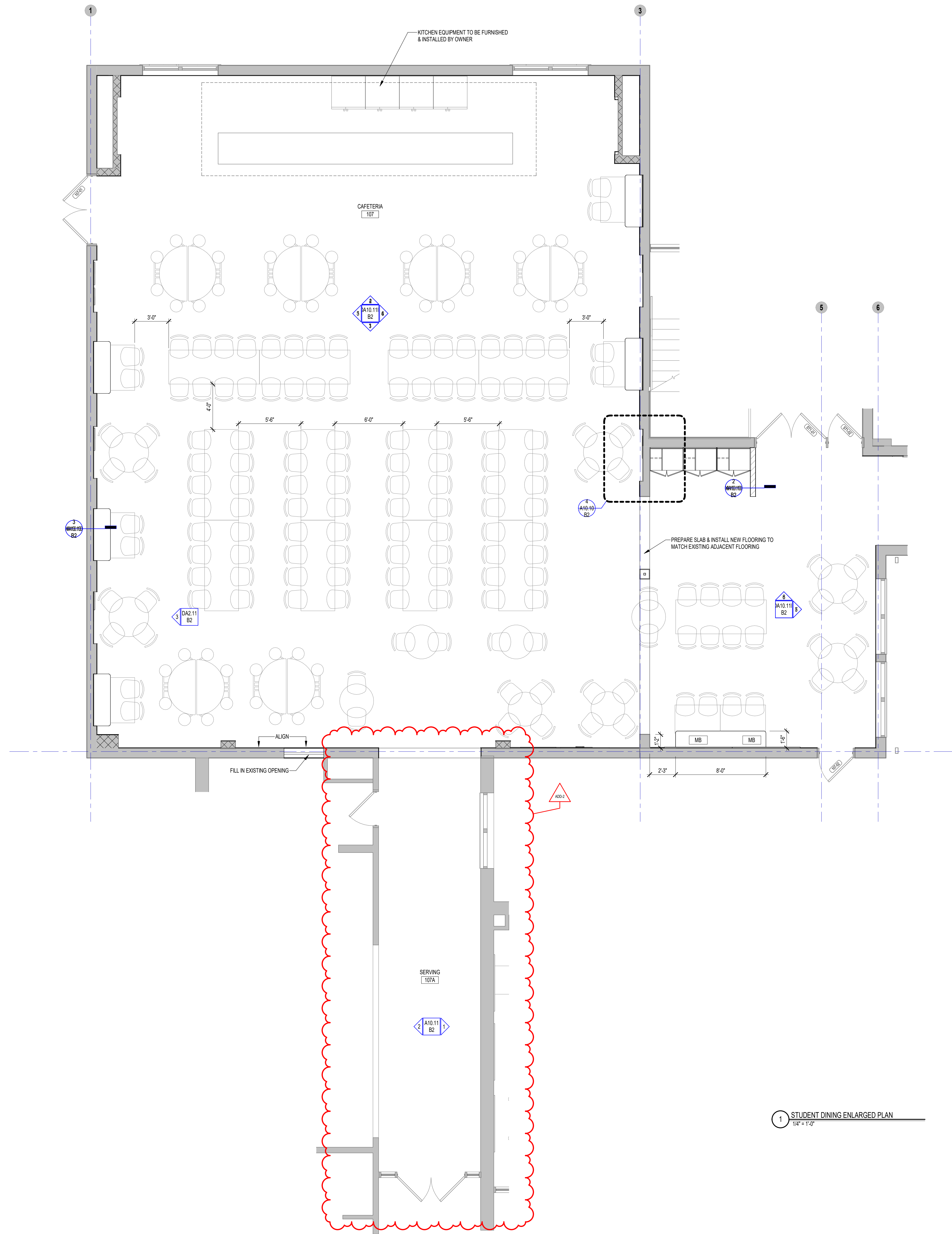

4 INTERIOR PLAN DETAIL
3/4" = 1'-0"

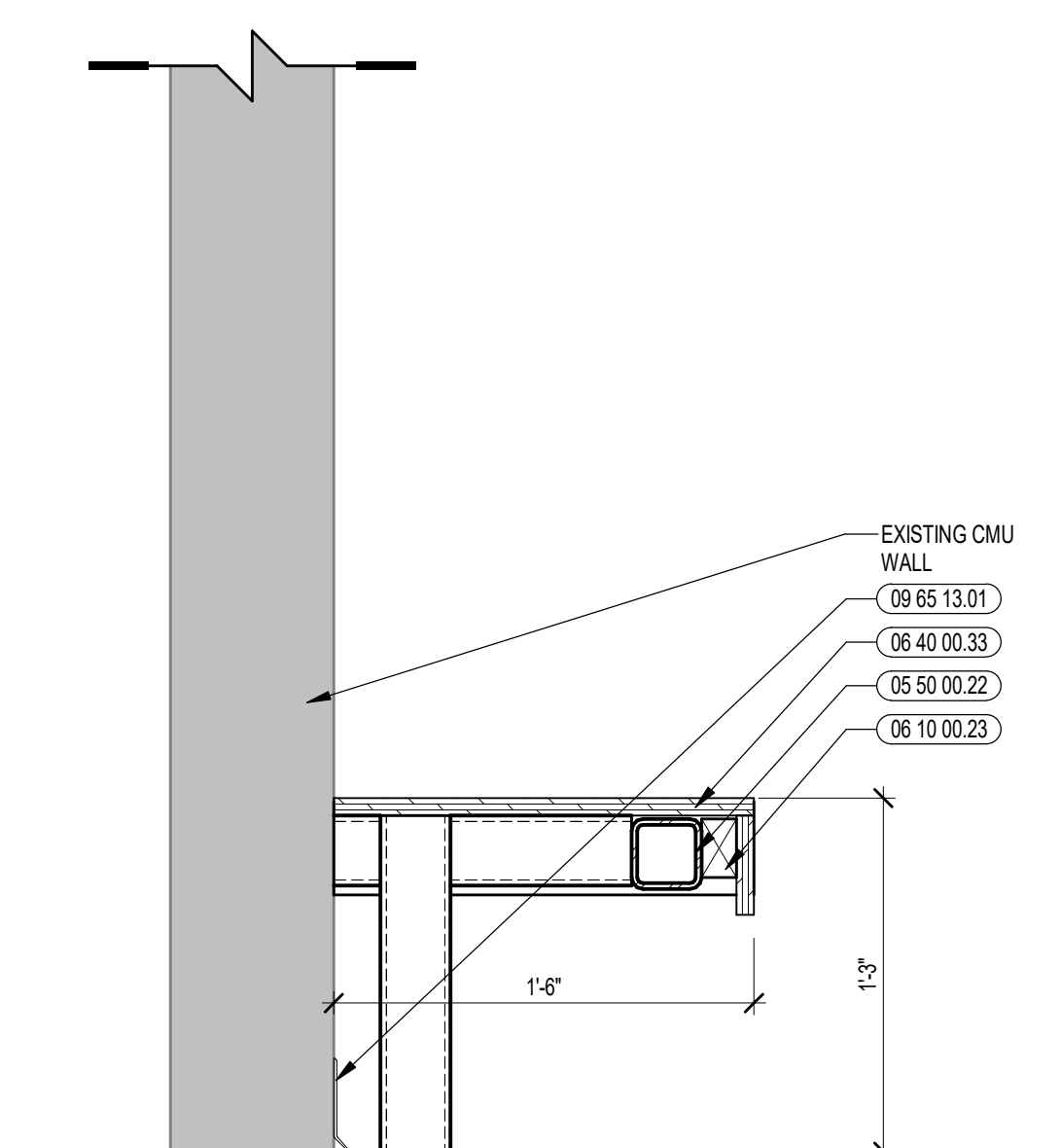

3 BENCH SECTION DETAIL
1/12" = 1'-0"

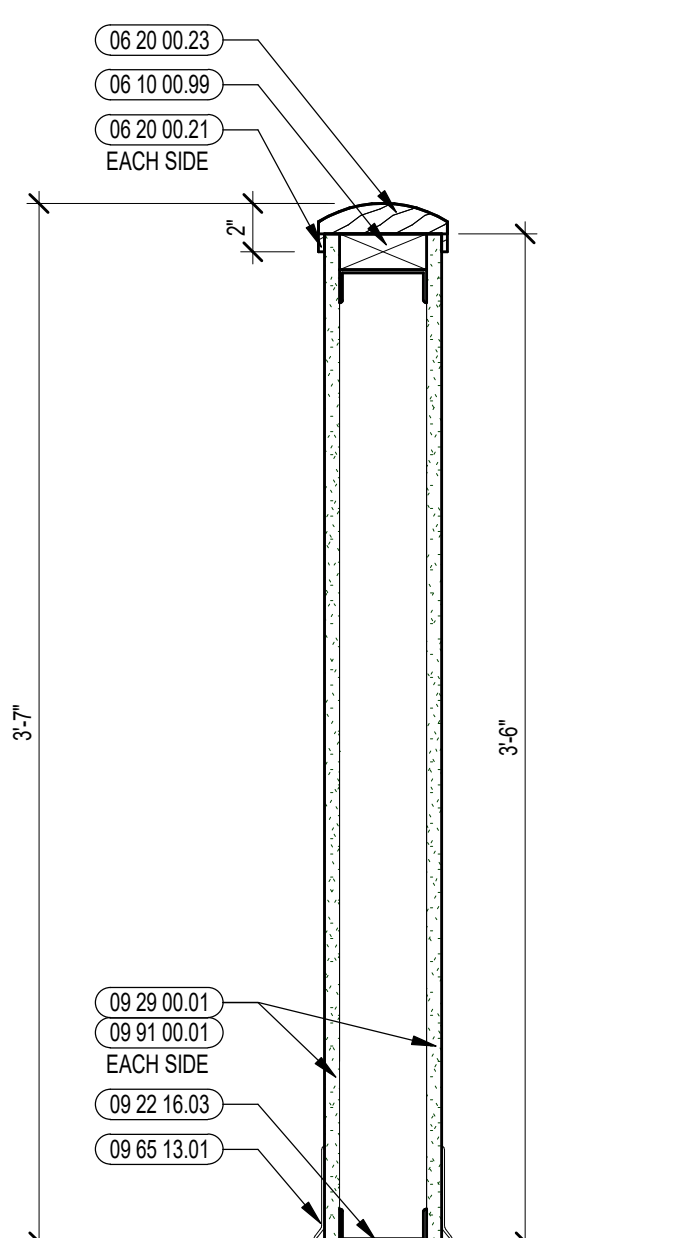

2 HALF WALL SECTION DETAIL
1/12" = 1'-0"

1 STUDENT DINING ENLARGED PLAN
1/4" = 1'-0"

Copyright © 2023, A3 Architects, LLC



112 WASHINGTON STREET
CENTRAL FALLS, RI 02863

KEYNOTE LEGEND:

- 09 29 00.01 5/8 INCH GYPSUM BOARD - LEVEL 4 FINISH - 1 LAYER
- 09 91 00.01 PAINT - SEE SCHEDULE
- 10 11 16.01 DRY MARKER BOARD
- 10 14 00.02 INTERIOR SIGNAGE - VINYL WALL GRAPHIC
- 12 30 00.03 TALL CABINET

ADDENDUM #2 ADD-2 7.10.2023
BID PACKAGE #2

KEY PLAN NORTH ARROW

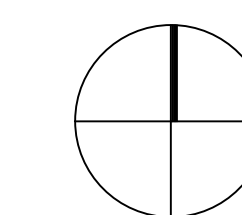

KEYPLAN

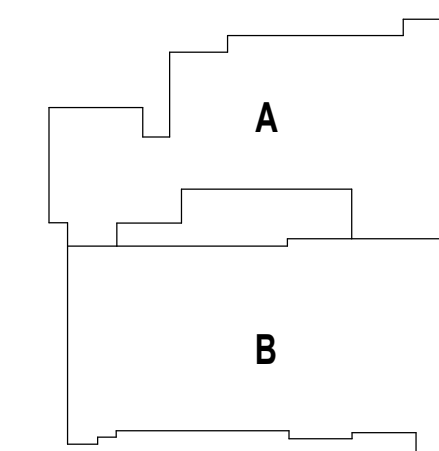

DRAWING NAME:

**STUDENT DINING
INTERIOR ELEVATIONS**

DRAWN BY: MS

REVIEWED BY: JQ

SCALE: AS INDICATED | DRAWING NUMBER:
JOB NO.: 2202.04
DATE: June 22, 2023 **A10.11 B2**

